

THIS DRAWING IS UNPUBLISHED. RELEASED FOR PUBLICATION
 © COPYRIGHT - BY TYCO ELECTRONICS CORPORATION. ALL RIGHTS RESERVED.

LOC	DIST	REVISIONS					
AF	50	P	LTR	DESCRIPTION	DATE	DWN	APVD
			H1	REV PER ECR-06-018933	11AUG06	HMR	KR

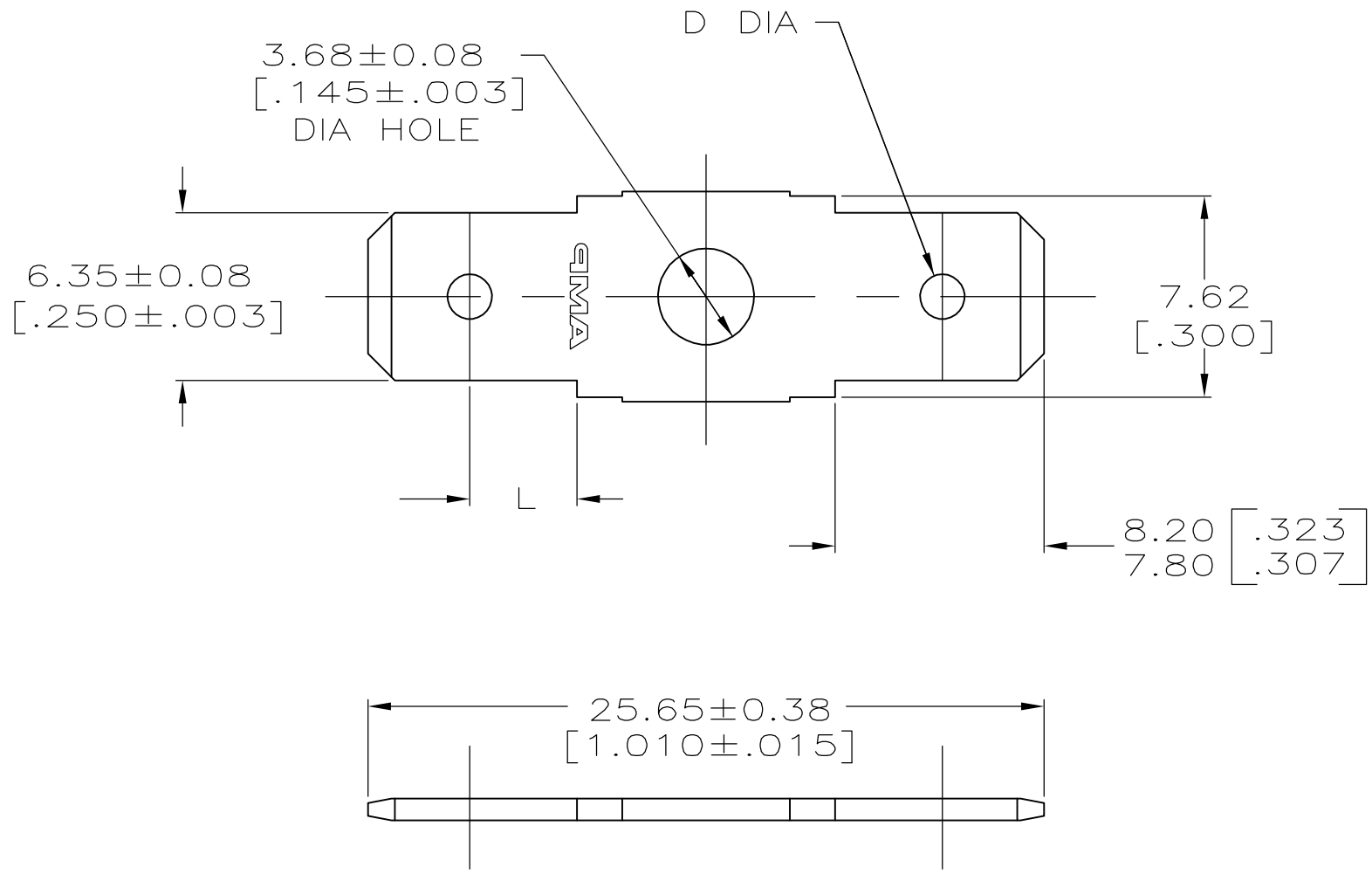

- 1 SUPPLIED IN LOOSE PIECE.
- 2 ELECTRICAL TEST TAB ONLY.
- 3 PRELIMINARY - NOT FOR PRODUCTION

2.03 [.080] 1.93 [.076] DIA HOLE	4.01±0.08 [.158±.003]	0.002032 [.000080] MIN TIN	0.813±0.012 [.032±.0005] CR STEEL	62627-4 3
2.03 [.080] 1.65 [.065] DIA HOLE	3.40±0.08 [.134±.003]	-	0.813±0.007 [.032±.0003] BRASS	62627-3
2.03 [.080] 1.65 [.065] DIA DIMPLE	4.06±0.08 [.160±.003]	-	0.813±0.007 [.032±.0003] BRASS	62627-2
		0.002032 [.000080] MIN TIN	0.813±0.012 [.032±.0005] CR STEEL	62627-1 2
DIM D	DIM L	FINISH	MATERIAL	PART NO.

THIS DRAWING IS A CONTROLLED DOCUMENT.		DWN	JR RUTH	8/6/96	 Tyco Electronics Corporation Harrisburg, PA 17105-3608
DIMENSIONS: mm [INCHES]		CHK	MS FEHER	8/6/96	
		APVD	P DESANTIS	8/6/96	
TOLERANCES UNLESS OTHERWISE SPECIFIED:		PRODUCT SPEC		NAME	
0 PLC ± -		-		TAB, FASTON, 6.35 [.250] SERIES	
1 PLC ± -		APPLICATION SPEC		-	
2 PLC ± 0.25 [.010]		-		SIZE	
3 PLC ± -		WEIGHT		CAGE CODE	
4 PLC ± -		-		DRAWING NO	
ANGLES ± -		-		RESTRICTED TO	
FINISH		-		-	
SEE TABLE		-		A3 00779 C-62627	
-		CUSTOMER DRAWING		SCALE 4:1	
-		-		SHEET 1 OF 1	
-		-		REV H1	